

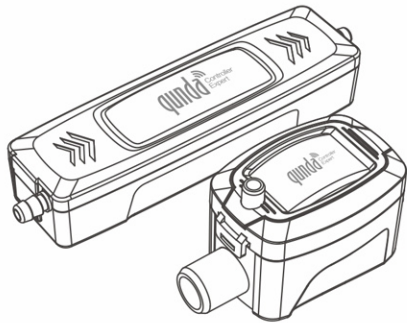

MINI SPLIT CONDENSATE PUMP MANUAL



- Ultra-quiet, Overflow stop
- Adopt the water level probe, safer and durable.

1. Product exhibition

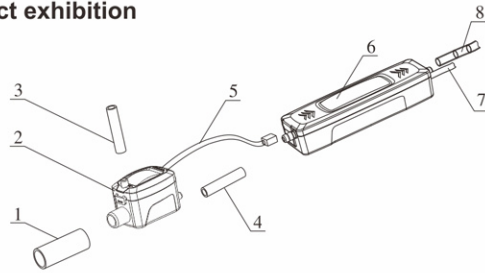

Item	Parts name	Item	Parts name	Item	Parts name
1	Inlet pipe	4	connecting pipe	7	Four-core line
2	Tank	5	Signal line	8	Outlet pipe
3	Air pipe	6	Pump motor		

2. Dimensions

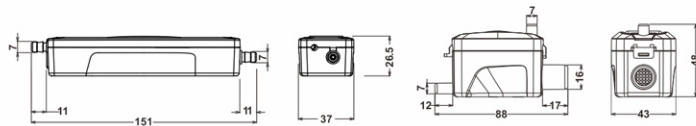

3. Parameters

Model	QD-PU22E
Power supply	AC 110~220V
Discharge head	Max.10m(33ft)
Flow rate	Max.23L/h(6.1GPH)
Tank capacity	45ml
Noise level	< 19dB(A)
Max air conditioner power	8KW(30,000btu/hr)
Max water temperature	35°C

4. Flow rate

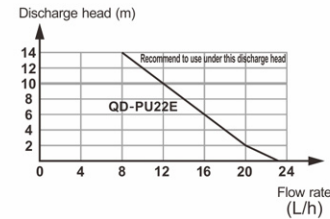

Model	Performance(L/h, Head)					
	0m	2m	4m	6m	8m	10m
QD-PU22E	23	20	18	16	14	12

5. Installation steps

- ① Connect the air pipe to the cylinder on the tank cover, as is shown. The silicon case can be took on to prevent the condensate.



- ② Make sure that the tank is horizontal, and the connection between the outlet pipe and water inlet is firmly. It's better to use the bandage to wrap it. (Equipped the inlet pipes with different shapes, please choose the proper one). As is shown.



- ③ Settle the pump motor at the proper place, as is shown

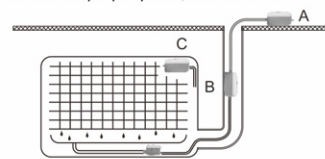

1

2

- ④ Using vibration-proof material to prevent the shake from making any noise.

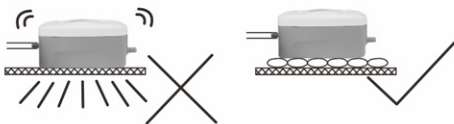

- ⑤ Pay attention to the flow direction, it should be same as the arrow on the cover.

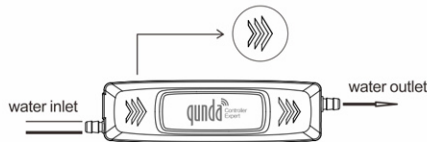

- ⑥ Connect the tank to the pump with the equipped pipe(the length of the pipe is 1.5m,so the distance between the tank and the motor can't be over 1.5m), and use the bandage to wrap it.

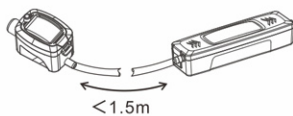

- ⑦ Connect the plastic pipe (OD 9mm*ID 6mm) to the outlet of the motor, and use the bandage to wrap it (please choose the proper length of the pipe as the matter of fact).

- ⑧ Connect the power line of the pump which is four-core,the different functions of the lines with different colors as below:
Power line: L line: red N line: black
Signal line: P1: yellow P2: white

To prevent the overflows from the failure and resulting property loss, we advice to connect the signal line, as is shown.

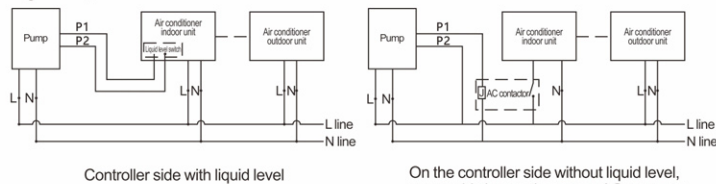

- ⑨ Correctly connected, power on the condensate pump and turn on the air conditioner. Please check if the pump works well, if not, please contact the maintainer to fix it.

Notice: 1. Please pay attention to the power line and signal line, do not connect wrong.
2. Without connecting the signal line, the pump will still work normally. In order to prevent the overflow failure, we advice to connect the signal line.

6. Overflow stop function

- When the water level in the tank is reaching the max capacity even it starts overflowing,
(1) If the signal line is connected, the air conditioner will be also cut off.
(2) If the signal line is not connected, please turn off the air conditioner and the pump right now.

7. ATTENTION!

- (1) Best if used in two years, after then we kindly suggest to replace a new one to prevent water leakage and property loss.
(2) If the pumps are installed with the air conditioner in the ceiling, please pay attention to the condition of power failure. Without power supply, it may result water leakage after using cool and dry mode.

8. Troubleshoot

Trouble	Reason	Solution
The pump is always working,can't stop	The tank is not horizontal	Adjust the place and make the tank being horizontal
	Any dirt inside of the tank	If the tank is not cleaned up in time, please do it right now
The pump starts to work and makes loud voice	The water in the pump siphons	To prevent the air goes into the tank and pump when installing and operating. Make sure the breather pipe connected well.
No water outflows when the pump is working	The pipe has an air leakage	Check if there is sludge or dirt
The pump can't start working	The pump can't start	Check the power is well connected
	Wrong connection	Check the corresponding lines are connected correctly
	Wrong power supply	Check if the line voltage is correct
The pump doesn't work, but there is water in it	Each pump has to past the test before they go out	Parts of the products are recent manufactured, it may have water left. It is normal, please use it without any worry

9. Attention

- 1.Place the tank horizontally, do not slant it.
- 2.The pump needs a separate power supply, if it needs to connect to the air conditioner, refer the wiring diagram.
- 3.Avoid the inlet water more than the outlet, or it may result overflowing.
- 4.Do not settle the pump outside or the place where easy to water flooding, to prevent the danger.
- 5.Please hire the professional technician to install the pump.

QUNDA Control Technology (Jiangsu) Co., Ltd.

Address: NO.888 Longqiao Road, Wujiang District, suzhou, jiangsu, China

Post code: 215200 Web site: www.qunda.net

★ The final explanatory right is reserved this company. Any alteration on the design and model will not be further notified.