



CONDENSATE PUMP

INSTRUCTION



•high lift & big flow rate.

•Unique water outlet to prevent backflow.

•Water level probe, safe and accurate.

•Overflow alarm and stop.

1. PRODUCT DRAWING

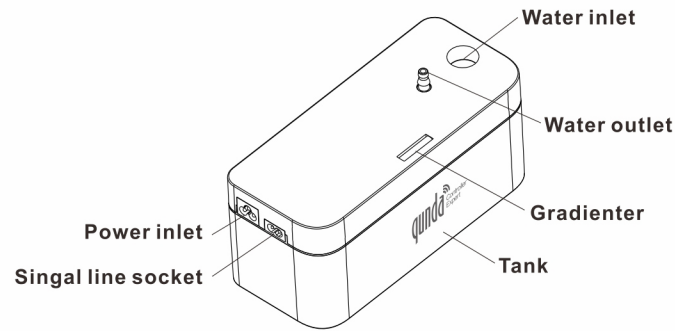

2. Dimensional drawing

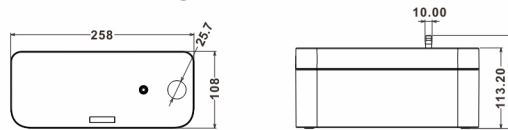

3. Parameters

Model	QD-PU03E	QD-PU03F
Power supply	AC 110~220V	AC 110~220V
Power	20W	30W
Discharge head	Max. 6m (20ft)	Max. 8m (26ft)
Flow rate	Max.200L/h (53GPH)	Max.260L/h (69GPH)
Tank capacity	1.8L	1.8L
Noise level	< 30dB(A)	< 30dB(A)
Max water temperature	35°C	35°C

1

4. Flow performance graph

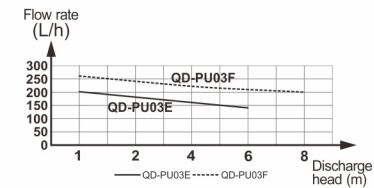

Model	Performance(L/h, Head)				
	1m	2m	4m	6m	8m
QD-PU03E	200	180	160	140	
QD-PU03F	260	240	220	210	200

5. Installation steps

- Cut off the power
- Settle the pump at a proper place where is horizontal, or stabilize the screws and hang the pump.
- Make sure the pump is settled horizontally, then connect the outlet pipe of the air conditioner to the water inlet of the pump.
- Connect the 8*12 pipe to the water outlet of the pump, and use the ribbon to stabilize it as shown.

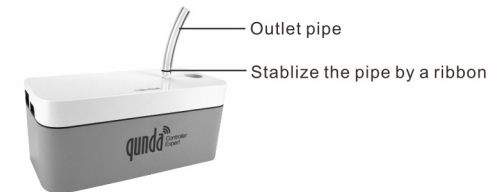

- Connect the power line and signal line, the pump can work normally without connecting the signal line as shown.



2

- According to the true circumstance, stick the insulation cotton on the surface of the tank to prevent the dew formation and dripping water.
- After correctly connected the system, start the power-on test, check the pump works normally. If the pump can't work, please contact the professional to fix it.
- When there is something blocking the water outlet, the water outlet can be disassembled manually and clean it. The details as shown.

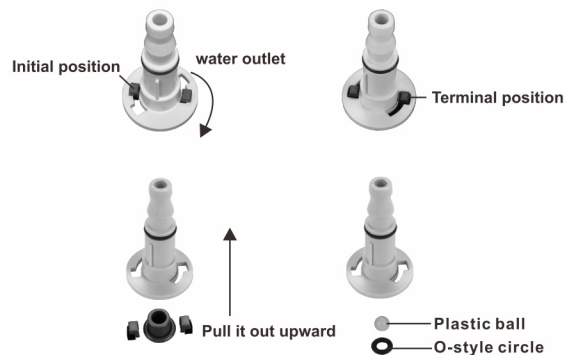

6. Overflow alarm and stop function

- When the water level in the tank is reaching the max capacity even it starts overflowing, the pump will alarm. If the signal line is connected, the air conditioner will be also cut off.
- If the signal line is not connected, once you heard the alarm, please turn off the air conditioner and the pump right now.

3

7. Troubleshoot

Trouble	Reason	Solution
The pump is always working, can't stop	The tank is not horizontal	Adjust the place and make the tank being horizontal
	Any dirt inside of the tank	If the tank is not cleaned up in time, please do it right now
The pump starts to work and makes loud voice	The water in the pump siphons	To prevent the air goes into the tank and pump when installing and operating. Make sure the breather pipe connected well.
No water outflows when the pump is working	The pipe has an air leakage	Check if there is sludge or dirt
The pump can't start working	The pump can't start	Check the power is well connected
	Wrong connection	Check the corresponding lines are connected correctly
The pump gives an alarm	Wrong power supply	Check if the line voltage is correct
	The water level in the pump is approaching the max capacity or has overflowed	Check if the outlet pipe buckled or has dirt inside
The pump doesn't work, but there is water in it	Check if the air conditioner power is over the pump range	
	Each pump has to past the test before they go out	Parts of the products are recent manufactured, it may have water left. It is normal, please use it without any worry

8. Attention

- Place the tank horizontally, don't slant it. After the installation, check the gradienter.
- Do not settle the pump outside or the place where is easy to water flooding, to prevent any danger.
- The pump needs independent power supply to keep continuous power.
- Prohibit the water discharge over the maximum, it may result the leakage.
- Please hire the professional technician to install the pump.

QUNDA Control Technology(Jiangsu)Co.,Ltd.

Address: NO.888 Longqiao Road, Wujiang District, Suzhou, Jiangsu, China

Post code: 215200 Web site: www.qunda.com

★ The final explanatory right is reserved this company. Any alteration on the design and model will not be further notified.

4